

RESIN ANCHORING AGENT



The anchoring agent is a kind of mastic bonding material made of unsaturated polyester resin for high strength anchoring agent, marble powder, accelerator and auxiliary materials in a certain proportion. Resin anchoring agent has the characteristics of quick curing at room temperature, high bonding strength, reliable anchoring force and good durability, especially suitable for rapid mechanized construction.



WhatsApp Code



HEBEI JIUFU INDUSTRIAL AND MINING PARTS CO., LTD.

+8615533040524

matthew@jfrockbolt.com
www.jfrockbolt.com

Product Features

- Easy to install, requiring no specialty injection equipment
- Resistant to anchoring failure caused by blasting or vibration
- Rapid anchoring of the bolt to the surrounding strata
- High load transfers achievable almost immediately
- Full column bonded bolts strongly resist the horizontal and lateral strata movement associated with convergence
- Provides strength and rigidity to prevent sag
- Acts as a reinforcement that clamps the individual strata layers into a single high strength beam

Rotation direction: Coal - Clockwise / Hard Rock - Anti Clockwise

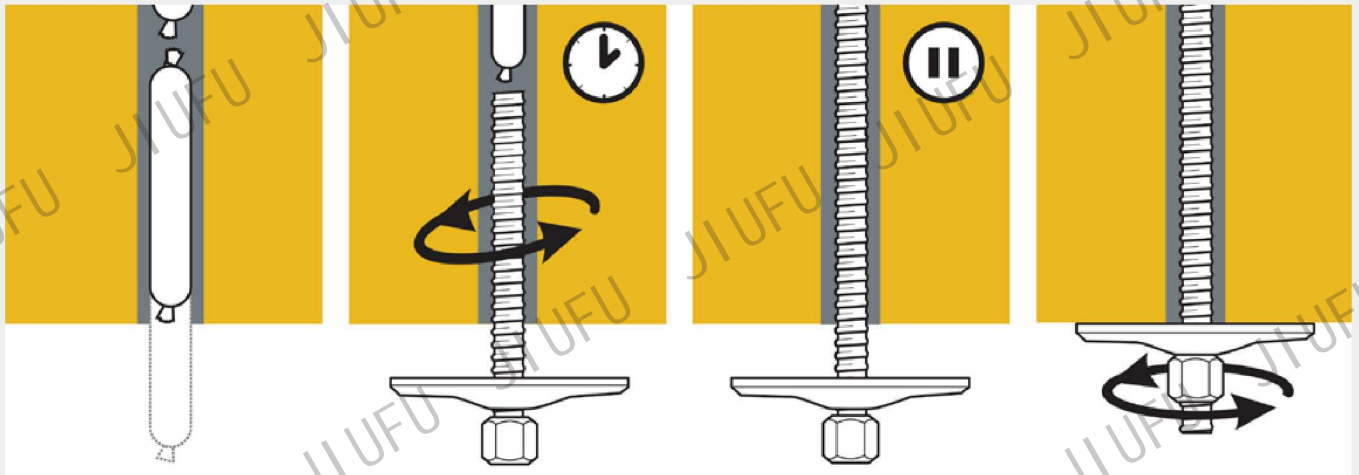

| Type | Diameter and length (mm* mm) | Weight (g) | Hole Diameter (m) | Piece/Box |
|--------|------------------------------|------------|-------------------|-----------|
| CK2335 | φ23*350 | 300±15 | φ28±2 | 50 |
| CK2360 | φ23*600 | 500±15 | φ28±2 | 50 |
| CK2835 | φ28*350 | 400±15 | φ32±2 | 40 |
| CK2850 | φ28*500 | 640±15 | φ32±2 | 40 |
| CK3535 | φ35*350 | 600±15 | φ42±2 | 20 |
| CK3540 | φ35*400 | 800±10 | φ42±2 | 20 |

| Speed | GelTime Seconds | Hold Time Seconds | Color Code |
|-------|-----------------|-------------------|------------|
| CKA | 8~25 | 10~30 | Yellow |
| CKB | 26~40 | 30~60 | Red |
| K | 41~90 | 90~180 | Blue |
| Z | 91~180 | 480 | White |
| M | > 180 | — | — |

HEBEI JIUFU INDUSTRIAL AND MINING PARTS CO., LTD.



+8615533040524

matthew@jfrockbolt.com ✉
www.jfrockbolt.com 🌐



JIUFU®